

JURY STRUTS

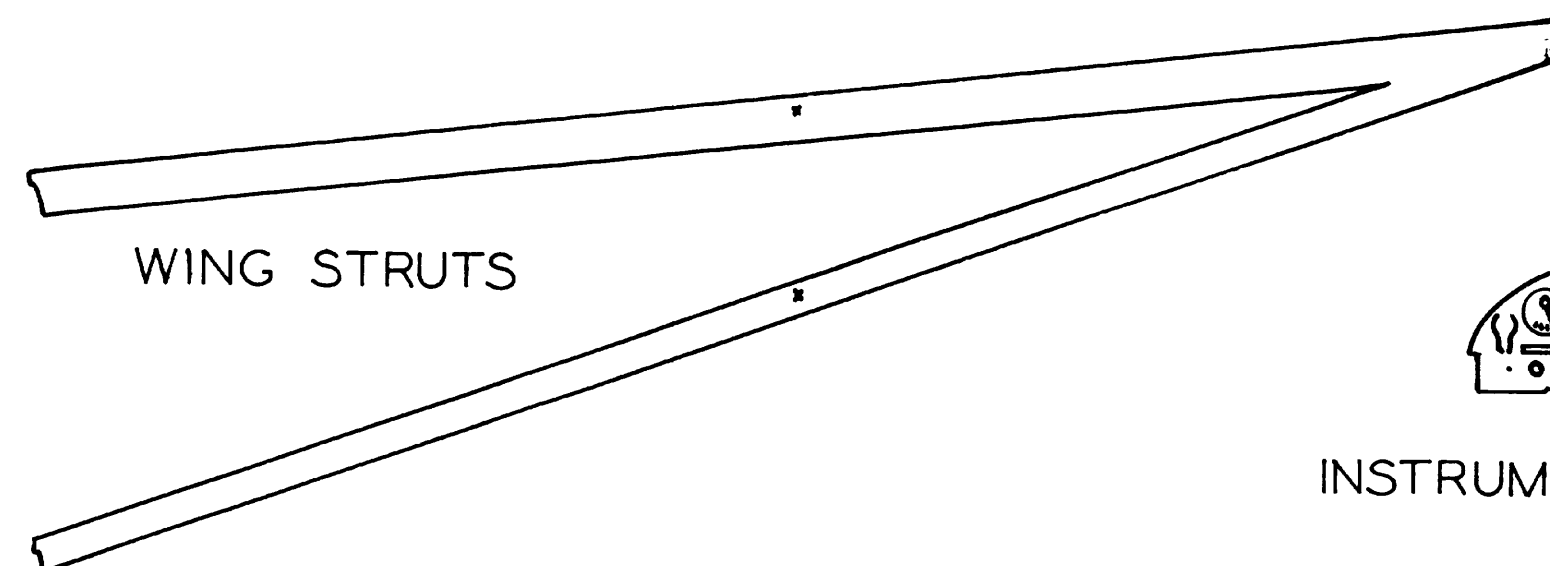

WING STRUTS

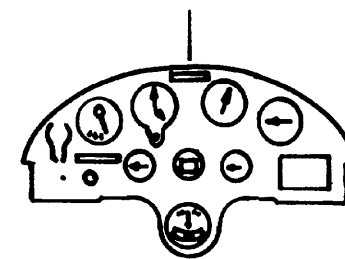

INSTRUMENT PANEL

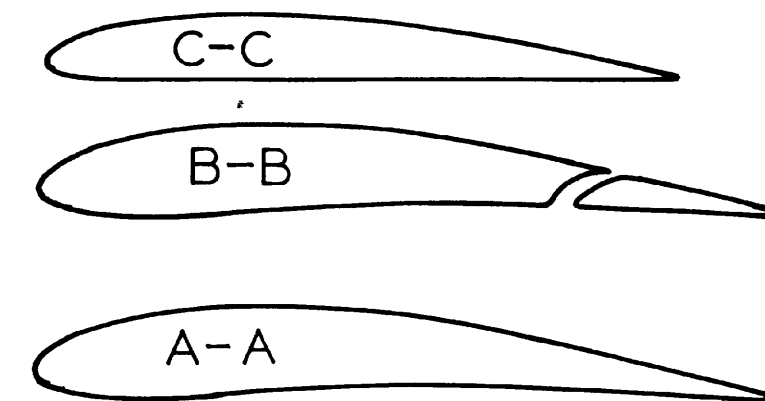

C-C

B-B

A-A

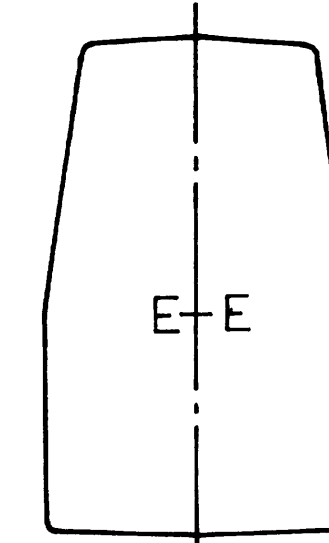

E-E

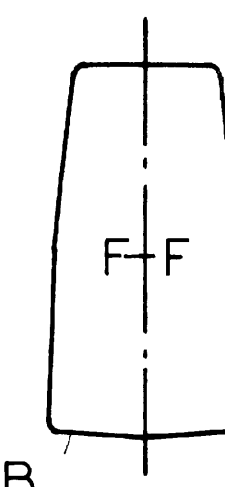

F-F



G-G

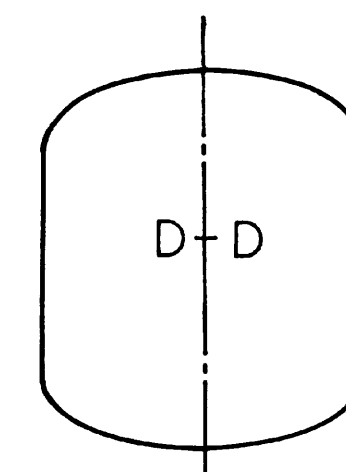

D-D

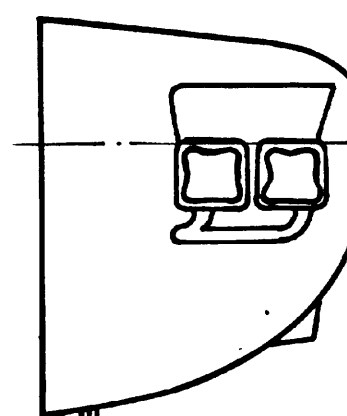

C

EXACT SCALE COMPONENTS AND CROSS SECTIONS ABOVE THIS LINE

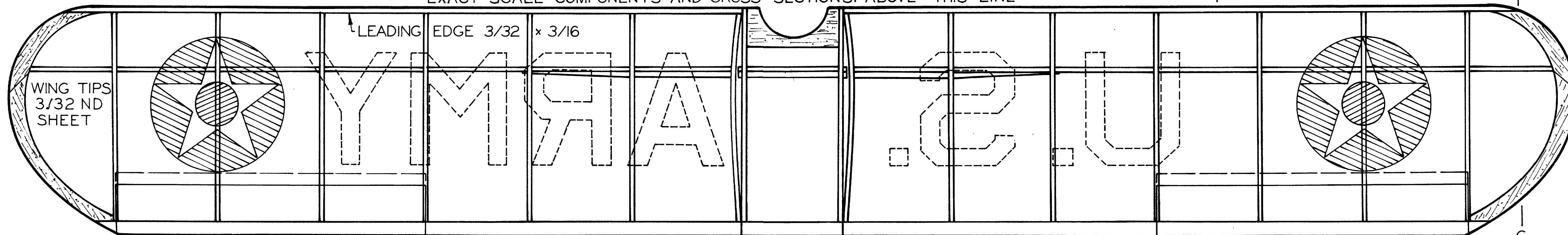

WING TIPS
3/32 ND
SHEET

LEADING EDGE 3/32 x 3/16

TRAILING EDGE 3/32 x 1/4

NOSE BLOCK IS
CARVED FROM A
LAMINATED FROM
3/32ND SHEET

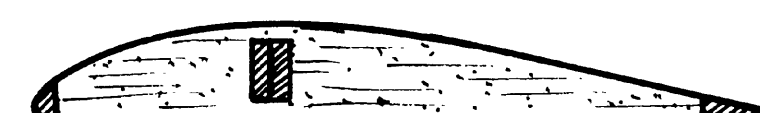

MAKE FOUR

WING RIBS



12 PLACES

SCALE TAIL OUTLINE

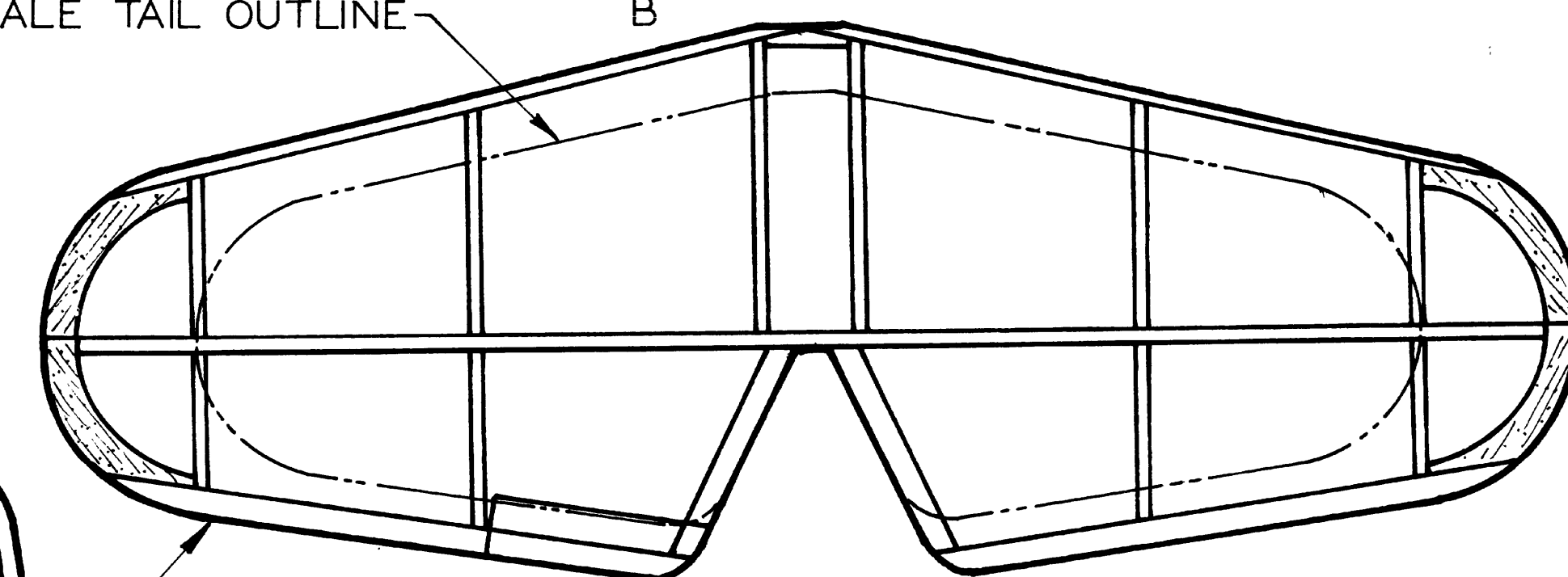

HORIZONTAL TAIL—ALL PIECES 3/32 THICK
AND VERTICAL TAIL

STRUTS 3/32 THICK

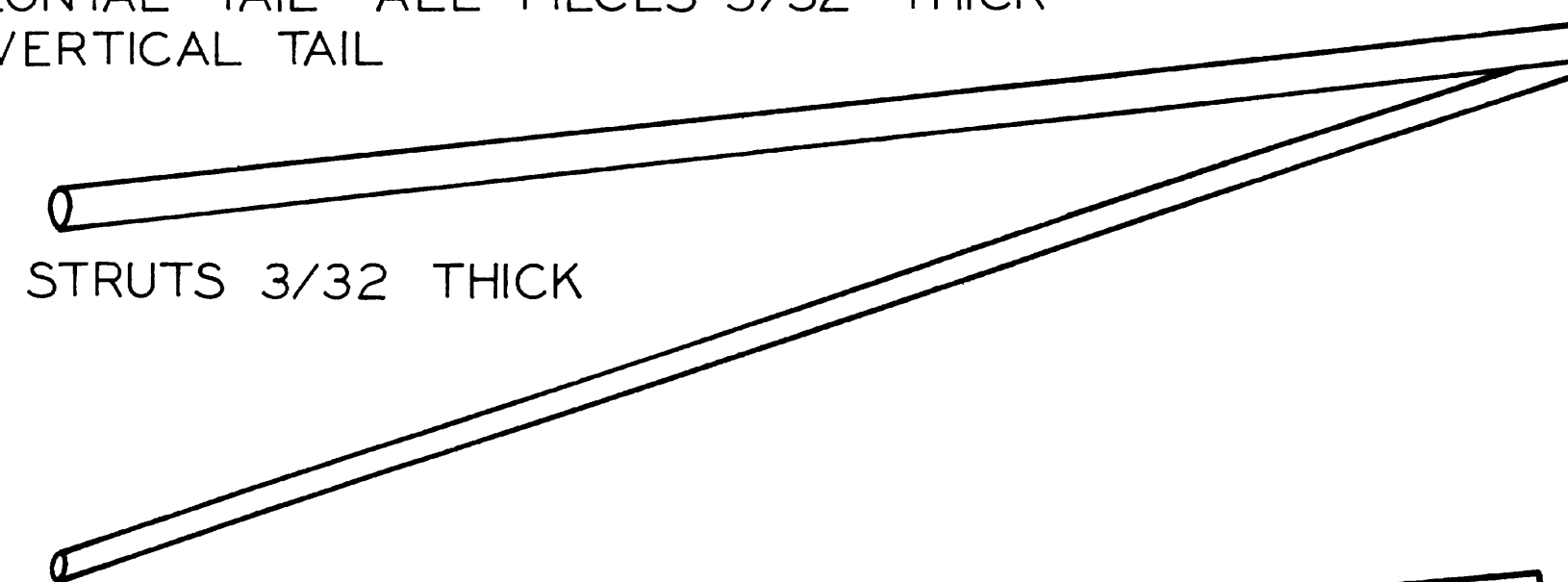

SPAR 3/32 x 5/16 MAKE TWO

CENTER SPAR AND SPAR SPLICE 3/32 SHEET

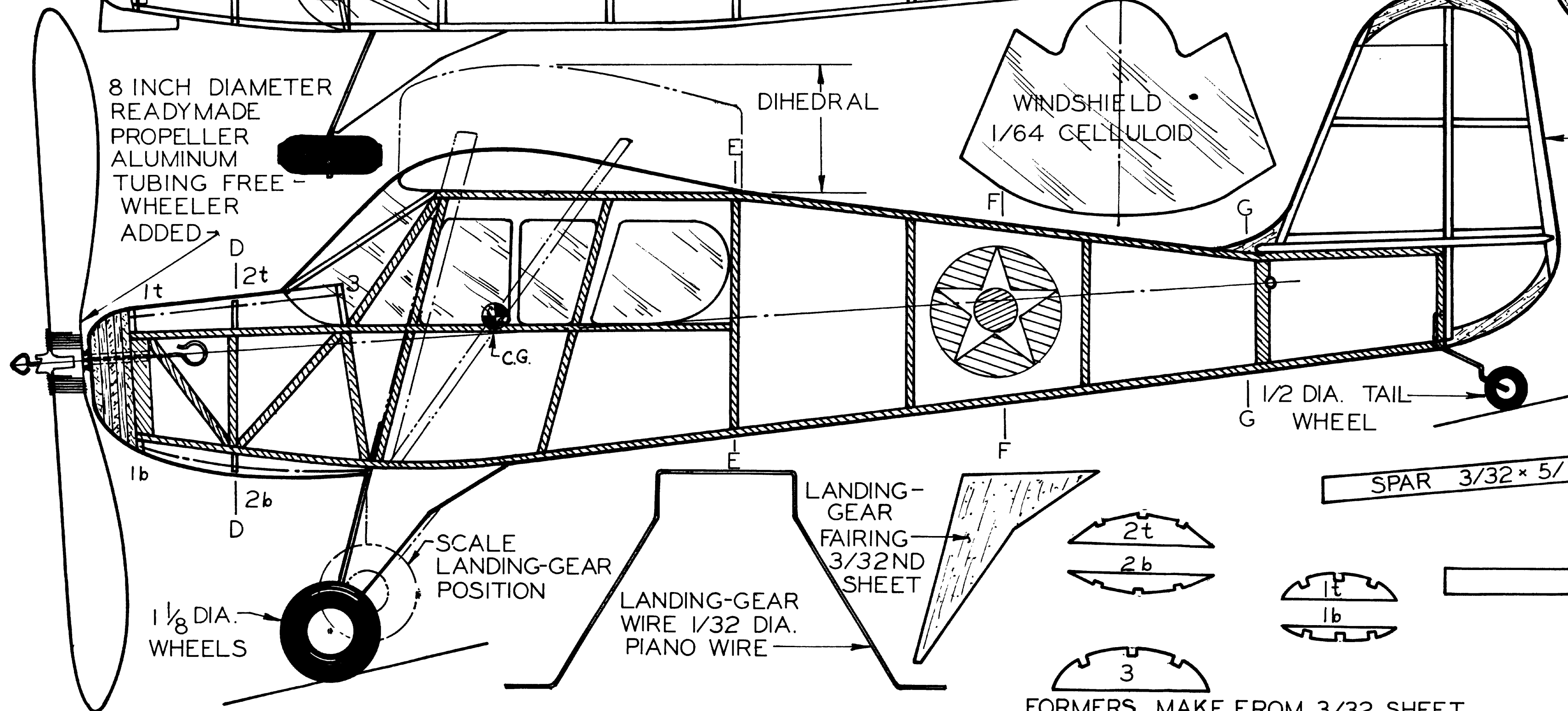
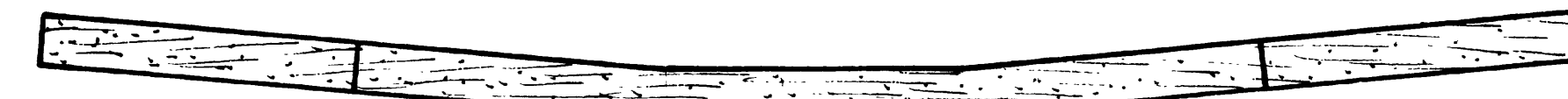

8 INCH DIAMETER
READYMADE
PROPELLER
ALUMINUM
TUBING FREE-
WHEELER
ADDED

DIHEDRAL

WINDSHIELD
1/64 CELULOID

1/2 DIA. TAIL
WHEEL

SCALE
LANDING-GEAR
POSITION

1 1/8 DIA.
WHEELS

LANDING-GEAR
WIRE 1/32 DIA.
PIANO WIRE

LANDING-
GEAR
FAIRING
3/32ND
SHEET

FORMERS, MAKE FROM 3/32 SHEET

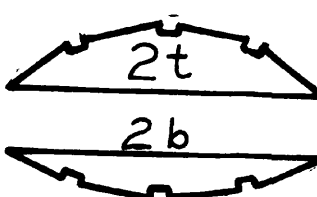

2t

2b

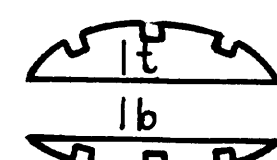

1t

1b

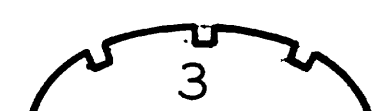

3

AERONCA DEFENDER
A RUBBER POWERED FLYING SCALE MODEL
Walt Mooney 12-5-62